

# Greenville Oaks Assisted Living

**Studio / One Bath**  
**274 Square Feet**

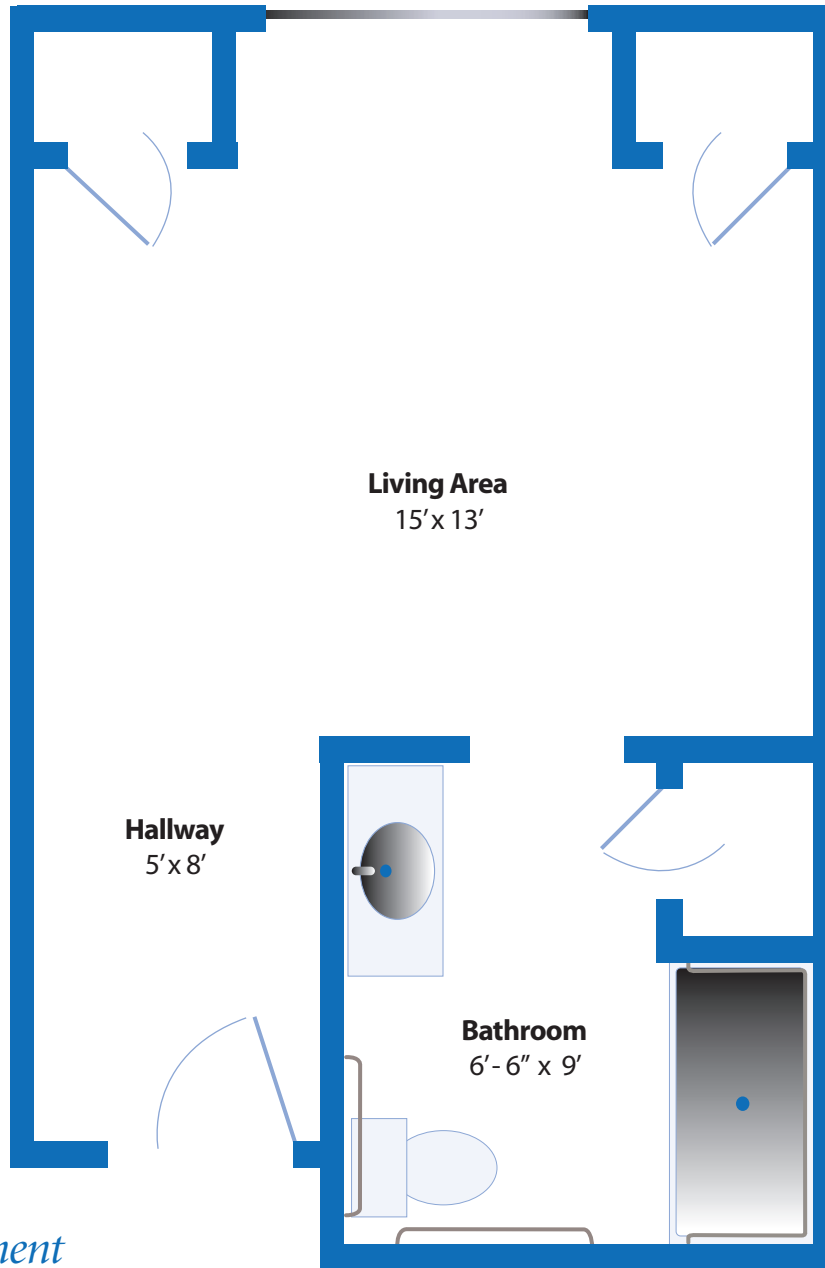

*Studio Apartment*

*274 Square Feet*

\$ \_\_\_\_\_

License #106750

# Greenville Oaks Assisted Living

**One Bedroom / One Bath**  
**541 Square Feet**

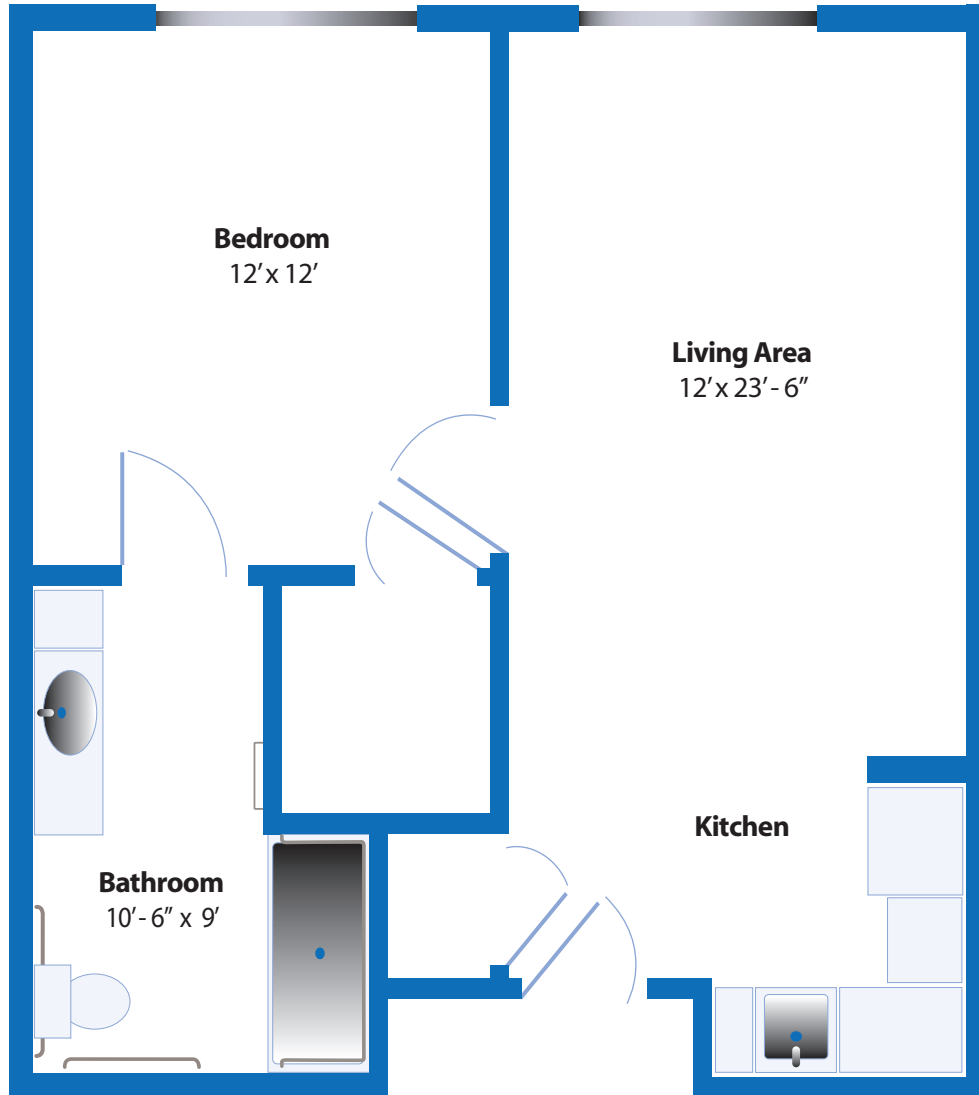

*541 Square Feet*

\$ \_\_\_\_\_

License #106750



# CHRISTIAN CARE

## COMMUNITIES & SERVICES

An Oakdale Seniors Alliance Supported Community

### Christan Care Allen Rates

UNIT DESCRIPTION	Size (SQ FT)	Monthly Service Fee
------------------	--------------	---------------------

#### Independent Living

1 Bedroom Small	790	\$3,295
1 Bedroom Large	1050	\$3,985
2 Bedroom, 2 Bathroom	1260	\$4,615

**Second Person Fee** **\$750**

*The monthly service fee includes all utilities, including internet and basic cable, with the exception of electricity and phone, two meals daily, weekly housekeeping services, and scheduled transportation.*

#### Assisted Living

Studio	274	\$4,615
One Bedroom	541	\$5,715

**Second Person Fee** **\$850**

*The monthly service fee covers all utilities, including internet and basic cable, except for phone. It also includes three daily meals, weekly housekeeping services, scheduled transportation, and an emergency pendant for added safety.*

#### Assisted Living | Level of Care

Level 1	\$0.00
Level 2	\$565
Level 3	\$1,070
Level 4	\$1,605
Enhanced	\$2,140

#### Memory Care

All-Inclusive	274	\$6,550
---------------	-----	---------

#### Memory Care | Level of Care

Enhanced	\$1,020
----------	---------

#### Community Fee

Assisted Living   Memory Care	\$2,000
Cottages	\$2,500

**Rates effective as of October 1, 2024 and are subject to change at any time.**

